

**Dimensions (In.)**  
(except where noted)

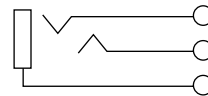
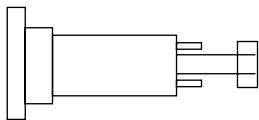
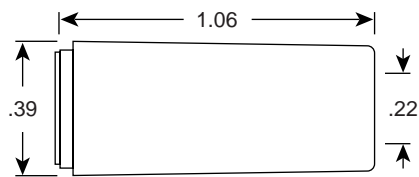
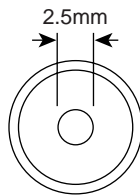

Jack body tolerance:  $\pm 0.2\text{mm}$   
Shell tolerance:  $\pm 0.5\text{mm}$

**Specifications:**

- Type: 2.5mm shielded stereo
- Body: brass
- Insulation: ABS plastic
- Shell: bakelite, black